

FOOTHILLS METROPOLITAN DISTRICT BOUNDARY EXHIBIT

S. COLLEGE AVE

E. SWALLOW RD

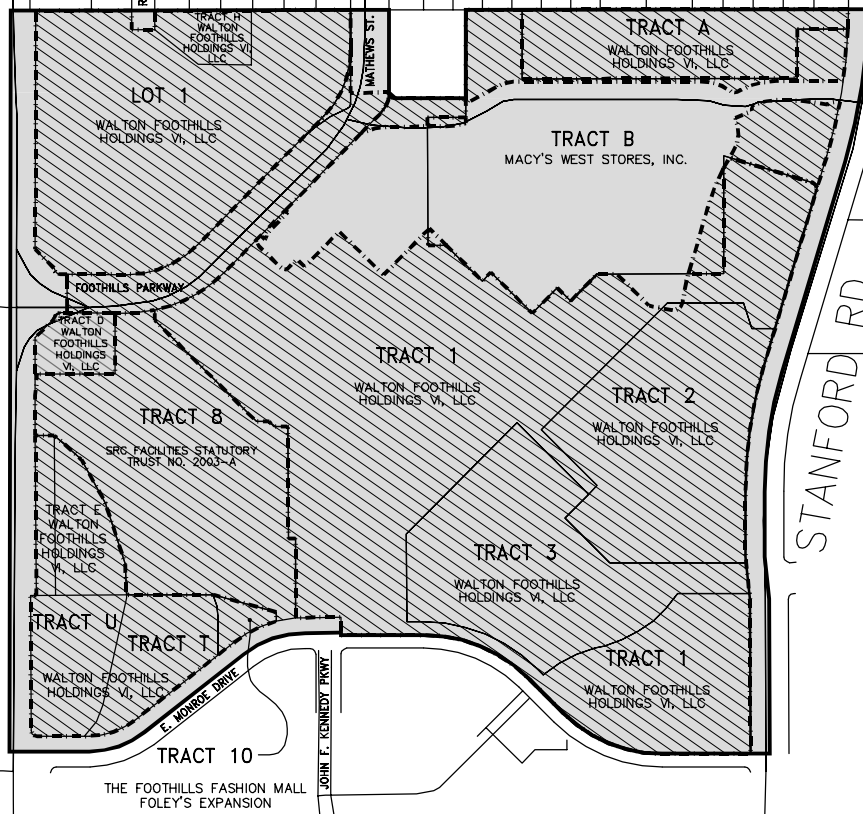

STANFORD RD

E. HORSETOOTH RD

P:\2012\0120302.00-Foothills Mall\Dwg\Exhibits\0120302_Foot-Hills-Mall_District_Boundaries-Revised.dwg | 3/13/2015 10:49 AM | dberglund

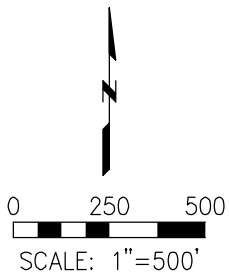

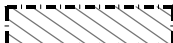
 = PROJECT BOUNDARY
 = BOUNDARIES OF METROPOLITAN DISTRICT

NOTE:

1. BOUNDARY LINES ARE BASED ON THE ALTA SURVEY DATED JUNE 20, 2012 AND FOOTHILLS MALL REDEVELOPMENT SUBDIVISION INCLUSION PARCEL EXHIBITS COMPUTED BY FARNSWORTH GROUP ON FEBRUARY 20, 2015.
2. THIS EXHIBIT DOES NOT REPRESENT A LAND SURVEY PLAT, IMPROVEMENT SURVEY PLAT OR IMPROVEMENT LOCATION CERTIFICATE AND DOES NOT CONSTITUTE A TITLE SEARCH BY FARNSWORTH GROUP, INC.

REVISED: 3/13/2015

Farnsworth GROUP
 1612 Specht Road, Suite 105
 FORT COLLINS, COLORADO 80525
 (970) 484-7477 / (970) 484-7488 Fax

FOOTHILLS METROPOLITAN DISTRICT
 BOUNDARY EXHIBIT
 FORT COLLINS, COLORADO

Project No: 0120302
 Book No:
 Drawn by: DJM
 Reviewed: DJB
 Date: 03/11/2015

SHEET 1 OF 1